

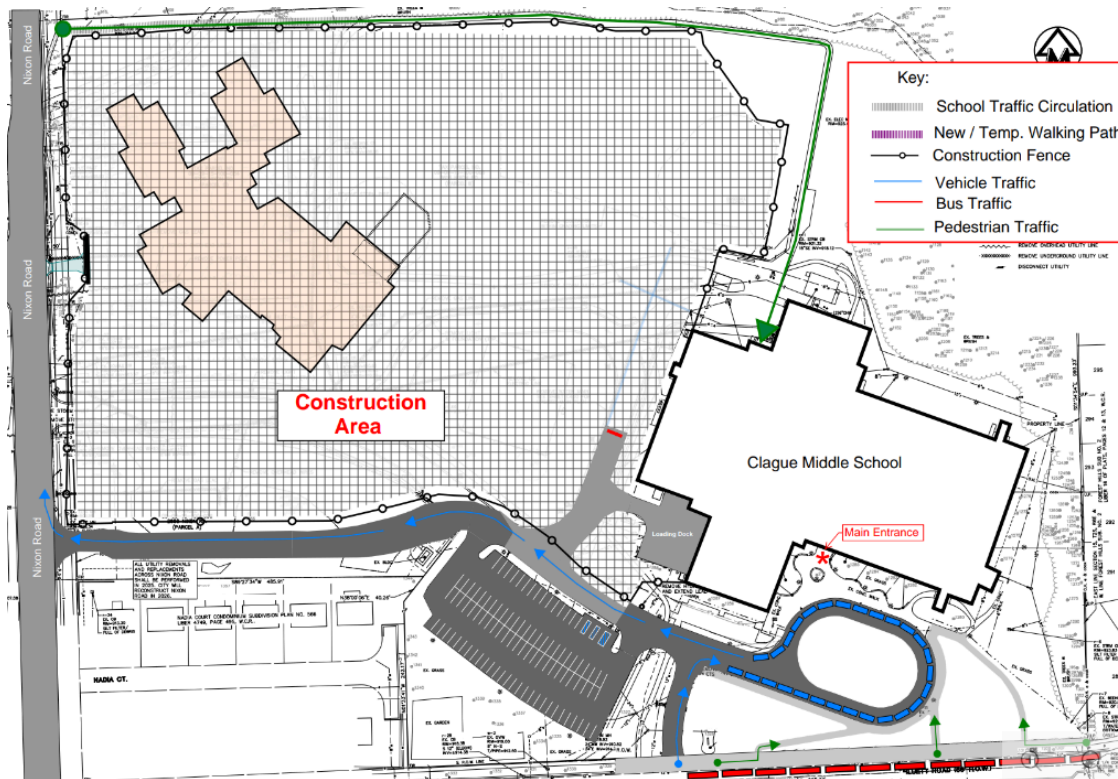

## New Logan ES @ Clague News - August 2025

To support construction of the new Logan Elementary, the following activities will take place on the Clague Middle School campus, and are referenced on the site plan below. To see all of the information related to this project in one place, please [click here visit to the New Logan Elementary page](#) and feel free to bookmark the page to revisit, as content will continue to be posted.

**New Clague vehicle traffic patterns are identified in blue below. The entry has changed and is now accessible from Bluett Road. *Please note: entry is no longer available from Nixon Road.***



### In Progress Activities, Weather Permitting:

- Ongoing utility work.
- Site grading and excavating for foundations continues.

- The construction manager will be installing Geothermal Heating, Cooling & Ventilation system as early as the first week of September, which represents a change from the posted schedule online.
  - AAPS has an emerging opportunity, because of contractor and equipment availability, at the Logan/Clague site to significantly move up timing on the geothermal drilling operation from Winter 2026 to September 2025. Geothermal is critical to the mechanical system start up as the system relies heavily on the geothermal bore field. This will allow more time to commission the HVAC system before school opens.
  - Additionally, it may help AAPS turn over some play fields, outdoor areas, etc. to Clague MS sooner than anticipated.
  - This work can be done without creating significant disruption to school operations, similar to the bore field that was recently completed at Mitchell ES while Summer School was in session.
  - Drilling crews typically operate from 7am to 7pm Monday through Saturday, within the City of Ann Arbor Noise Ordinance and is expected to take about 5-6 months.

**Please note:**

- Construction parking and construction access drives are for construction personnel only and to ensure safety, staff and parents should refrain from using construction parking and/or drives.
- Emails will continue to be sent, to provide updates on campus activities.



This new elementary school is made possible by Bond and Sinking Funds. Ann Arbor Public Schools wishes to thank the Community for the continued support of the Capital Program Bond and Sinking Funds.

AAPS Capital Program's objective is to transform the student learning experience with the goal of providing for the health, safety, and well-being of all students in high-quality, equitable, and environmentally sustainable schools.

