

## PIONEER HIGH SCHOOL

The AAPS Capital Improvements Program continues to develop and implement projects outlined in the 2019 Bond Campaign and the BOE approved Bond Plan. These improvements are consistent with the needs outlined in the facility condition assessment report.

### Project Information

Scope of Work	Location of Work
<p><b>Bid Package 102 Pioneer High School – Emergency Paging / Clock System Upgrade</b> Remove all existing clock / paging device &amp; system &amp; Replace with Advance Tech System. Install devices at new locations, previously did not have devices Replace damaged sidewalk slabs</p> <p><b>Bid Package 103 General Trades</b> – Perform Ceiling repair, Drywall repair and final painting to restore affected areas during the paging / clock system install.</p>	Entire Interior Will Be Affected by This Project
<p><b>Solar Expansion</b> Expand existing solar array and add solar canopy.</p>	Roof and Exterior

### Project Contacts

Construction Manager Site Superintendent	AAPS Representative (Envelope – interior Scope)	AAPS Representative (Solar)	AAPS (Solar Consultant)
Patrick O’Dell	IAN A. STEWART	Aron Mayes	Jeff Eckhout
Brix Corporation	Gilbane Building Company	Gilbane Building Company	Nova Consultants
734-751-8711	231-730-2839	734-639-4691	313-246-0434 Ext 1024
<a href="mailto:Podell@brixcorporation.com">Podell@brixcorporation.com</a>	<a href="mailto:istewart@GilbaneCo.com">istewart@GilbaneCo.com</a>	<a href="mailto:Amayes12@gilbaneco.com">Amayes12@gilbaneco.com</a>	<a href="mailto:Jeff.Eckhout@novaconsultants.com">Jeff.Eckhout@novaconsultants.com</a>

### Project Schedule

TIMELINE:	Construction Activities
May, 2026	Emergency Paging - Project Pull – Ahead Work Begins (2 <sup>nd</sup> Shift)
June 09, 2026	School Ends – Solar Work Begins
August 2026	Solar Ends
August 23, 2026	Emergency Paging Project Completion
August 24, 2026	First Day of School for Students (Anticipated)

Project Location & Maps:

## Paging / Clock System Upgrade

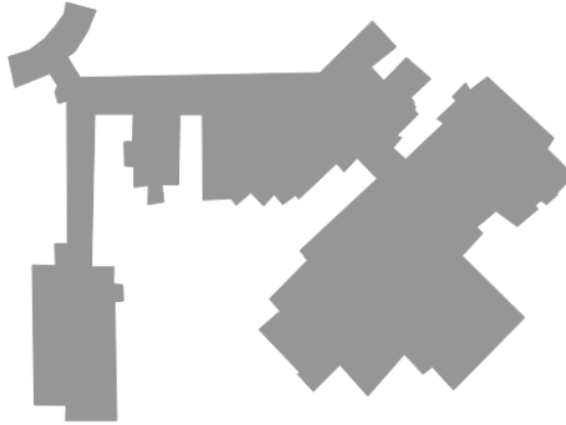

## Solar Expansion

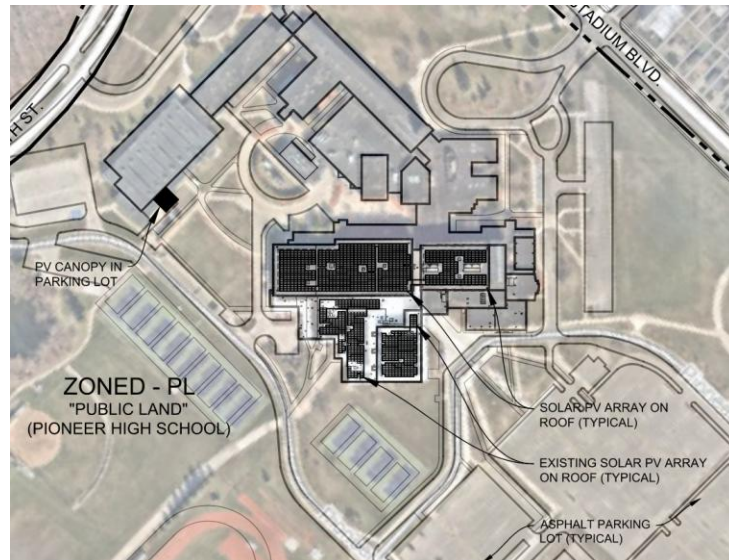

There may be areas that require coordination of the work to be completed, impacted staff/departments will be contacted directly.



[www.a2schoolsbond.org](http://www.a2schoolsbond.org)

[www.a2schoolsbond.org/staff-info](http://www.a2schoolsbond.org/staff-info)